

STATE	STATE PROJECT REFERENCE NO.	SHEET NO.	TOTAL SHEETS
N.C.	17BP.1.R.16 (360025)	1	11

**STATE OF NORTH CAROLINA
DEPARTMENT OF TRANSPORTATION
DIVISION OF HIGHWAYS
GEOTECHNICAL ENGINEERING UNIT**

**STRUCTURE
SUBSURFACE INVESTIGATION**

PROJ. REFERENCE NO. 17BP.1.R.16 (360025) F.A. PROJ. NA
 COUNTY GATES
 PROJECT DESCRIPTION BRIDGE NO. 360025 ON NC 137 OVER COLE CREEK

CONTENTS

<u>SHEET</u>	<u>DESCRIPTION</u>
1	TITLE SHEET
2 - 2A	LEGEND
3	SITE PLAN
4 - II	BORING LOGS

PERSONNEL

M. BACHMAN

A. LOFTIN

TRIGON LLC

INVESTIGATED BY D. CARR

CHECKED BY P. ZHANG

SUBMITTED BY P. ZHANG

DATE MAY 2012

CAUTION NOTICE

THE SUBSURFACE INFORMATION AND THE SUBSURFACE INVESTIGATION ON WHICH IT IS BASED WERE MADE FOR THE PURPOSE OF STUDY, PLANNING, AND DESIGN, AND NOT FOR CONSTRUCTION OR PAY PURPOSES. THE VARIOUS FIELD BORING LOGS, ROCK CORES, AND SOIL TEST DATA AVAILABLE MAY BE REVIEWED OR INSPECTED IN RALEIGH BY CONTACTING THE N. C. DEPARTMENT OF TRANSPORTATION, GEOTECHNICAL ENGINEERING UNIT AT (919) 707-6850. NEITHER THE SUBSURFACE PLANS AND REPORTS, NOR THE FIELD BORING LOGS, ROCK CORES, OR SOIL TEST DATA ARE PART OF THE CONTRACT.

GENERAL SOIL AND ROCK STRATA DESCRIPTIONS AND INDICATED BOUNDARIES ARE BASED ON A GEOTECHNICAL INTERPRETATION OF ALL AVAILABLE SUBSURFACE DATA AND MAY NOT NECESSARILY REFLECT THE ACTUAL SUBSURFACE CONDITIONS BETWEEN BORINGS OR BETWEEN SAMPLED STRATA WITHIN THE BOREHOLE. THE LABORATORY SAMPLE DATA AND THE IN SITU (IN-PLACE) TEST DATA CAN BE RELIED ON ONLY TO THE DEGREE OF RELIABILITY INHERENT IN THE STANDARD TEST METHOD. THE OBSERVED WATER LEVELS OR SOIL MOISTURE CONDITIONS INDICATED IN THE SUBSURFACE INVESTIGATIONS ARE AS RECORDED AT THE TIME OF THE INVESTIGATION. THESE WATER LEVELS OR SOIL MOISTURE CONDITIONS MAY VARY CONSIDERABLY WITH TIME ACCORDING TO CLIMATIC CONDITIONS INCLUDING TEMPERATURES, PRECIPITATION, AND WIND, AS WELL AS OTHER NON-CLIMATIC FACTORS.

THE BIDDER OR CONTRACTOR IS CAUTIONED THAT DETAILS SHOWN ON THE SUBSURFACE PLANS ARE PRELIMINARY ONLY AND IN MANY CASES THE FINAL DESIGN DETAILS ARE DIFFERENT. FOR BIDDING AND CONSTRUCTION PURPOSES, REFER TO THE CONSTRUCTION PLANS AND DOCUMENTS FOR FINAL DESIGN INFORMATION ON THIS PROJECT. THE DEPARTMENT DOES NOT WARRANT OR GUARANTEE THE SUFFICIENCY OR ACCURACY OF THE INVESTIGATION MADE, NOR THE INTERPRETATIONS MADE, OR OPINION OF THE DEPARTMENT AS TO THE TYPE OF MATERIALS AND CONDITIONS TO BE ENCOUNTERED. THE BIDDER OR CONTRACTOR IS CAUTIONED TO MAKE SUCH INDEPENDENT SUBSURFACE INVESTIGATIONS AS HE DEEMS NECESSARY TO SATISFY HIMSELF AS TO CONDITIONS TO BE ENCOUNTERED ON THIS PROJECT. THE CONTRACTOR SHALL HAVE NO CLAIM FOR ADDITIONAL COMPENSATION OR FOR AN EXTENSION OF TIME FOR ANY REASON RESULTING FROM THE ACTUAL CONDITIONS ENCOUNTERED AT THE SITE DIFFERING FROM THOSE INDICATED IN THE SUBSURFACE INFORMATION.

NOTE - THE INFORMATION CONTAINED HEREIN IS NOT IMPLIED OR GUARANTEED BY THE N. C. DEPARTMENT OF TRANSPORTATION AS BEING ACCURATE NOR IT IS CONSIDERED TO BE PART OF THE PLANS, SPECIFICATIONS, OR CONTRACT FOR THE PROJECT.

NOTE - BY HAVING REQUESTED THIS INFORMATION THE CONTRACTOR SPECIFICALLY WAIVES ANY CLAIMS FOR INCREASED COMPENSATION OR EXTENSION OF TIME BASED ON DIFFERENCES BETWEEN THE CONDITIONS INDICATED HEREIN AND THE ACTUAL CONDITIONS AT THE PROJECT SITE.

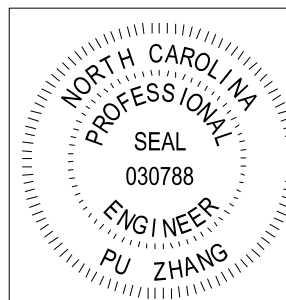

[Signature]
5-28-12

SIGNATURE

DRAWN BY: S. CROCKETT

**NORTH CAROLINA DEPARTMENT OF TRANSPORTATION
DIVISION OF HIGHWAYS
GEOTECHNICAL ENGINEERING UNIT
SOIL AND ROCK LEGEND, TERMS, SYMBOLS, AND ABBREVIATIONS**

SOIL DESCRIPTION										GRADATION																																																									
SOIL IS CONSIDERED TO BE THE UNCONSOLIDATED, SEMI-CONSOLIDATED, OR WEATHERED EARTH MATERIALS THAT CAN BE PENETRATED WITH A CONTINUOUS FLIGHT POWER AUGER, AND YIELD LESS THAN 100 BLOWS PER FOOT ACCORDING TO STANDARD PENETRATION TEST (AASHTO T206, ASTM D-1586). SOIL CLASSIFICATION IS BASED ON THE AASHTO SYSTEM. BASIC DESCRIPTIONS GENERALLY SHALL INCLUDE: CONSISTENCY, COLOR, TEXTURE, MOISTURE, AASHTO CLASSIFICATION, AND OTHER PERTINENT FACTORS SUCH AS MINERALOGICAL COMPOSITION, ANGULARITY, STRUCTURE, PLASTICITY, ETC. EXAMPLE: <i>VERY STIFF, GRN, SILTY CLAY, MOST WITH INTERBEDDED FINE SAND LAYERS, HIGHLY PLASTIC, A-7-6</i>										WELL GRADED - INDICATES A GOOD REPRESENTATION OF PARTICLE SIZES FROM FINE TO COARSE. UNIFORM - INDICATES THAT SOIL PARTICLES ARE ALL APPROXIMATELY THE SAME SIZE. (ALSO POORLY GRADED) GAP-GRADED - INDICATES A MIXTURE OF UNIFORM PARTICLES OF TWO OR MORE SIZES.																																																									
										ANGULARITY OF GRAINS										THE ANGULARITY OR ROUNDNESS OF SOIL GRAINS IS DESIGNATED BY THE TERMS <u>ANGULAR</u> , <u>SUBANGULAR</u> , <u>SUBROUNDED</u> , OR <u>ROUNDED</u> .																																															
SOIL LEGEND AND AASHTO CLASSIFICATION										MINERALOGICAL COMPOSITION																																																									
GENERAL CLASS. GRANULAR MATERIALS (<= 35% PASSING #200) SILT-CLAY MATERIALS (> 35% PASSING #200) ORGANIC MATERIALS										MINERAL NAMES SUCH AS QUARTZ, FELDSPAR, MICA, TALC, KAOLIN, ETC. ARE USED IN DESCRIPTIONS WHENEVER THEY ARE CONSIDERED OF SIGNIFICANCE.																																																									
GROUP CLASS. A-1, A-3, A-2, A-4, A-5, A-6, A-7, A-1, A-2, A-3, A-4, A-5, A-6, A-7										COMPRESSIBILITY																																																									
SYMBOL										SLIGHTLY COMPRESSIBLE LIQUID LIMIT LESS THAN 31 MODERATELY COMPRESSIBLE LIQUID LIMIT EQUAL TO 31-50 HIGHLY COMPRESSIBLE LIQUID LIMIT GREATER THAN 50																																																									
% PASSING: 10, 40, 200 (50 MX, 30 MX, 15 MX, 51 MN, 35 MX, 41 MN, 10 MX, 11 MN, 40 MX, 11 MN, 40 MX, 11 MN, 40 MX, 11 MN, 40 MX, 11 MN)										PERCENTAGE OF MATERIAL																																																									
LIQUID LIMIT PLASTIC INDEX GROUP INDEX USUAL TYPES OF MAJOR MATERIALS GEN. RATING AS A SUBGRADE										<table border="1" style="width:100%; border-collapse: collapse;"> <thead> <tr> <th>ORGANIC MATERIAL</th> <th>GRANULAR SOILS</th> <th>SILT - CLAY SOILS</th> <th>OTHER MATERIAL</th> </tr> </thead> <tbody> <tr> <td>TRACE OF ORGANIC MATTER</td> <td>2 - 3%</td> <td>3 - 5%</td> <td>TRACE</td> </tr> <tr> <td>LITTLE ORGANIC MATTER</td> <td>3 - 5%</td> <td>5 - 12%</td> <td>LITTLE</td> </tr> <tr> <td>MODERATELY ORGANIC</td> <td>5 - 10%</td> <td>12 - 20%</td> <td>SOME</td> </tr> <tr> <td>HIGHLY ORGANIC</td> <td>>10%</td> <td>>20%</td> <td>HIGHLY</td> </tr> <tr> <td></td> <td></td> <td></td> <td>1 - 10%</td> </tr> <tr> <td></td> <td></td> <td></td> <td>10 - 20%</td> </tr> <tr> <td></td> <td></td> <td></td> <td>20 - 35%</td> </tr> <tr> <td></td> <td></td> <td></td> <td>35% AND ABOVE</td> </tr> </tbody> </table>										ORGANIC MATERIAL	GRANULAR SOILS	SILT - CLAY SOILS	OTHER MATERIAL	TRACE OF ORGANIC MATTER	2 - 3%	3 - 5%	TRACE	LITTLE ORGANIC MATTER	3 - 5%	5 - 12%	LITTLE	MODERATELY ORGANIC	5 - 10%	12 - 20%	SOME	HIGHLY ORGANIC	>10%	>20%	HIGHLY				1 - 10%				10 - 20%				20 - 35%				35% AND ABOVE												
ORGANIC MATERIAL	GRANULAR SOILS	SILT - CLAY SOILS	OTHER MATERIAL																																																																
TRACE OF ORGANIC MATTER	2 - 3%	3 - 5%	TRACE																																																																
LITTLE ORGANIC MATTER	3 - 5%	5 - 12%	LITTLE																																																																
MODERATELY ORGANIC	5 - 10%	12 - 20%	SOME																																																																
HIGHLY ORGANIC	>10%	>20%	HIGHLY																																																																
			1 - 10%																																																																
			10 - 20%																																																																
			20 - 35%																																																																
			35% AND ABOVE																																																																
PI OF A-7-5 SUBGROUP IS ≤ LL - 30 ; PI OF A-7-6 SUBGROUP IS > LL - 30										GROUND WATER																																																									
										WATER LEVEL IN BORE HOLE IMMEDIATELY AFTER DRILLING STATIC WATER LEVEL AFTER 24 HOURS PERCHED WATER, SATURATED ZONE, OR WATER BEARING STRATA SPRING OR SEEP																																																									
CONSISTENCY OR DENSENESS										MISCELLANEOUS SYMBOLS																																																									
<table border="1" style="width:100%; border-collapse: collapse;"> <thead> <tr> <th>PRIMARY SOIL TYPE</th> <th>COMPACTNESS OR CONSISTENCY</th> <th>RANGE OF STANDARD PENETRATION RESISTANCE (N-VALUE)</th> <th>RANGE OF UNCONFINED COMPRESSIVE STRENGTH (TONS/F²)</th> </tr> </thead> <tbody> <tr> <td>GENERALLY GRANULAR MATERIAL (NON-COHESIVE)</td> <td>VERY LOOSE LOOSE MEDIUM DENSE DENSE VERY DENSE</td> <td><4 4 TO 10 10 TO 30 30 TO 50 >50</td> <td>N/A</td> </tr> <tr> <td>GENERALLY SILT-CLAY MATERIAL (COHESIVE)</td> <td>VERY SOFT SOFT MEDIUM STIFF STIFF VERY STIFF HARD</td> <td><2 2 TO 4 4 TO 8 8 TO 15 15 TO 30 >30</td> <td><0.25 0.25 TO 0.50 0.5 TO 1.0 1 TO 2 2 TO 4 >4</td> </tr> </tbody> </table>										PRIMARY SOIL TYPE	COMPACTNESS OR CONSISTENCY	RANGE OF STANDARD PENETRATION RESISTANCE (N-VALUE)	RANGE OF UNCONFINED COMPRESSIVE STRENGTH (TONS/F ²)	GENERALLY GRANULAR MATERIAL (NON-COHESIVE)	VERY LOOSE LOOSE MEDIUM DENSE DENSE VERY DENSE	<4 4 TO 10 10 TO 30 30 TO 50 >50	N/A	GENERALLY SILT-CLAY MATERIAL (COHESIVE)	VERY SOFT SOFT MEDIUM STIFF STIFF VERY STIFF HARD	<2 2 TO 4 4 TO 8 8 TO 15 15 TO 30 >30	<0.25 0.25 TO 0.50 0.5 TO 1.0 1 TO 2 2 TO 4 >4																																														
PRIMARY SOIL TYPE	COMPACTNESS OR CONSISTENCY	RANGE OF STANDARD PENETRATION RESISTANCE (N-VALUE)	RANGE OF UNCONFINED COMPRESSIVE STRENGTH (TONS/F ²)																																																																
GENERALLY GRANULAR MATERIAL (NON-COHESIVE)	VERY LOOSE LOOSE MEDIUM DENSE DENSE VERY DENSE	<4 4 TO 10 10 TO 30 30 TO 50 >50	N/A																																																																
GENERALLY SILT-CLAY MATERIAL (COHESIVE)	VERY SOFT SOFT MEDIUM STIFF STIFF VERY STIFF HARD	<2 2 TO 4 4 TO 8 8 TO 15 15 TO 30 >30	<0.25 0.25 TO 0.50 0.5 TO 1.0 1 TO 2 2 TO 4 >4																																																																
TEXTURE OR GRAIN SIZE										ABBREVIATIONS																																																									
<table border="1" style="width:100%; border-collapse: collapse;"> <thead> <tr> <th>U.S. STD. SIEVE SIZE OPENING (MM)</th> <th>4</th> <th>10</th> <th>40</th> <th>60</th> <th>200</th> <th>270</th> </tr> </thead> <tbody> <tr> <td></td> <td>4.76</td> <td>2.00</td> <td>0.42</td> <td>0.25</td> <td>0.075</td> <td>0.053</td> </tr> </tbody> </table>										U.S. STD. SIEVE SIZE OPENING (MM)	4	10	40	60	200	270		4.76	2.00	0.42	0.25	0.075	0.053	<table border="1" style="width:100%; border-collapse: collapse;"> <thead> <tr> <th>BOULDER (BLDR.)</th> <th>COBBLE (COB.)</th> <th>GRAVEL (GR.)</th> <th>COARSE SAND (CSE. SD.)</th> <th>FINE SAND (F SD.)</th> <th>SILT (SL.)</th> <th>CLAY (CL.)</th> </tr> </thead> <tbody> <tr> <td>GRAIN SIZE MM 305</td> <td>75</td> <td>2.0</td> <td>0.25</td> <td>0.05</td> <td>0.005</td> <td></td> </tr> <tr> <td>IN. 12</td> <td>3</td> <td></td> <td></td> <td></td> <td></td> <td></td> </tr> </tbody> </table>										BOULDER (BLDR.)	COBBLE (COB.)	GRAVEL (GR.)	COARSE SAND (CSE. SD.)	FINE SAND (F SD.)	SILT (SL.)	CLAY (CL.)	GRAIN SIZE MM 305	75	2.0	0.25	0.05	0.005		IN. 12	3																		
U.S. STD. SIEVE SIZE OPENING (MM)	4	10	40	60	200	270																																																													
	4.76	2.00	0.42	0.25	0.075	0.053																																																													
BOULDER (BLDR.)	COBBLE (COB.)	GRAVEL (GR.)	COARSE SAND (CSE. SD.)	FINE SAND (F SD.)	SILT (SL.)	CLAY (CL.)																																																													
GRAIN SIZE MM 305	75	2.0	0.25	0.05	0.005																																																														
IN. 12	3																																																																		
SOIL MOISTURE - CORRELATION OF TERMS										EQUIPMENT USED ON SUBJECT PROJECT																																																									
<table border="1" style="width:100%; border-collapse: collapse;"> <thead> <tr> <th>SOIL MOISTURE SCALE (ATTERBERG LIMITS)</th> <th>FIELD MOISTURE DESCRIPTION</th> <th>GUIDE FOR FIELD MOISTURE DESCRIPTION</th> </tr> </thead> <tbody> <tr> <td>LL - LIQUID LIMIT</td> <td>- SATURATED - (SAT.)</td> <td>USUALLY LIQUID; VERY WET, USUALLY FROM BELOW THE GROUND WATER TABLE</td> </tr> <tr> <td>PL - PLASTIC LIMIT</td> <td>- WET - (W)</td> <td>SEMISOLID; REQUIRES DRYING TO ATTAIN OPTIMUM MOISTURE</td> </tr> <tr> <td>OM - OPTIMUM MOISTURE</td> <td>- MOIST - (M)</td> <td>SOLID; AT OR NEAR OPTIMUM MOISTURE</td> </tr> <tr> <td>SL - SHRINKAGE LIMIT</td> <td>- DRY - (D)</td> <td>REQUIRES ADDITIONAL WATER TO ATTAIN OPTIMUM MOISTURE</td> </tr> </tbody> </table>										SOIL MOISTURE SCALE (ATTERBERG LIMITS)	FIELD MOISTURE DESCRIPTION	GUIDE FOR FIELD MOISTURE DESCRIPTION	LL - LIQUID LIMIT	- SATURATED - (SAT.)	USUALLY LIQUID; VERY WET, USUALLY FROM BELOW THE GROUND WATER TABLE	PL - PLASTIC LIMIT	- WET - (W)	SEMISOLID; REQUIRES DRYING TO ATTAIN OPTIMUM MOISTURE	OM - OPTIMUM MOISTURE	- MOIST - (M)	SOLID; AT OR NEAR OPTIMUM MOISTURE	SL - SHRINKAGE LIMIT	- DRY - (D)	REQUIRES ADDITIONAL WATER TO ATTAIN OPTIMUM MOISTURE	<table border="1" style="width:100%; border-collapse: collapse;"> <thead> <tr> <th>DRILL UNITS:</th> <th>ADVANCING TOOLS:</th> <th>HAMMER TYPE:</th> </tr> </thead> <tbody> <tr> <td><input type="checkbox"/> MOBILE B-___</td> <td><input type="checkbox"/> CLAY BITS</td> <td><input checked="" type="checkbox"/> AUTOMATIC <input type="checkbox"/> MANUAL</td> </tr> <tr> <td><input type="checkbox"/> BK-51</td> <td><input type="checkbox"/> 6" CONTINUOUS FLIGHT AUGER</td> <td>CORE SIZE:</td> </tr> <tr> <td><input type="checkbox"/> CME-45C</td> <td><input type="checkbox"/> 8" HOLLOW AUGERS</td> <td><input type="checkbox"/> -B___</td> </tr> <tr> <td><input type="checkbox"/> CME-550</td> <td><input type="checkbox"/> HARD FACED FINGER BITS</td> <td><input type="checkbox"/> -N___</td> </tr> <tr> <td><input type="checkbox"/> PORTABLE HOIST</td> <td><input type="checkbox"/> TUNG-CARBIDE INSERTS</td> <td><input type="checkbox"/> -H___</td> </tr> <tr> <td><input checked="" type="checkbox"/> CME-55</td> <td><input checked="" type="checkbox"/> CASING <input checked="" type="checkbox"/> W/ ADVANCER</td> <td>HAND TOOLS:</td> </tr> <tr> <td><input type="checkbox"/> _____</td> <td><input type="checkbox"/> TRICONE _____ STEEL TEETH</td> <td><input type="checkbox"/> POST HOLE DIGGER</td> </tr> <tr> <td><input type="checkbox"/> _____</td> <td><input type="checkbox"/> TRICONE _____ TUNG-CARB.</td> <td><input type="checkbox"/> HAND AUGER</td> </tr> <tr> <td><input type="checkbox"/> _____</td> <td><input type="checkbox"/> CORE BIT</td> <td><input type="checkbox"/> SOUNDING ROD</td> </tr> <tr> <td><input checked="" type="checkbox"/> _____</td> <td><input checked="" type="checkbox"/> MUD ROTARY</td> <td><input type="checkbox"/> VANE SHEAR TEST</td> </tr> </tbody> </table>										DRILL UNITS:	ADVANCING TOOLS:	HAMMER TYPE:	<input type="checkbox"/> MOBILE B-___	<input type="checkbox"/> CLAY BITS	<input checked="" type="checkbox"/> AUTOMATIC <input type="checkbox"/> MANUAL	<input type="checkbox"/> BK-51	<input type="checkbox"/> 6" CONTINUOUS FLIGHT AUGER	CORE SIZE:	<input type="checkbox"/> CME-45C	<input type="checkbox"/> 8" HOLLOW AUGERS	<input type="checkbox"/> -B___	<input type="checkbox"/> CME-550	<input type="checkbox"/> HARD FACED FINGER BITS	<input type="checkbox"/> -N___	<input type="checkbox"/> PORTABLE HOIST	<input type="checkbox"/> TUNG-CARBIDE INSERTS	<input type="checkbox"/> -H___	<input checked="" type="checkbox"/> CME-55	<input checked="" type="checkbox"/> CASING <input checked="" type="checkbox"/> W/ ADVANCER	HAND TOOLS:	<input type="checkbox"/> _____	<input type="checkbox"/> TRICONE _____ STEEL TEETH	<input type="checkbox"/> POST HOLE DIGGER	<input type="checkbox"/> _____	<input type="checkbox"/> TRICONE _____ TUNG-CARB.	<input type="checkbox"/> HAND AUGER	<input type="checkbox"/> _____	<input type="checkbox"/> CORE BIT	<input type="checkbox"/> SOUNDING ROD	<input checked="" type="checkbox"/> _____	<input checked="" type="checkbox"/> MUD ROTARY	<input type="checkbox"/> VANE SHEAR TEST
SOIL MOISTURE SCALE (ATTERBERG LIMITS)	FIELD MOISTURE DESCRIPTION	GUIDE FOR FIELD MOISTURE DESCRIPTION																																																																	
LL - LIQUID LIMIT	- SATURATED - (SAT.)	USUALLY LIQUID; VERY WET, USUALLY FROM BELOW THE GROUND WATER TABLE																																																																	
PL - PLASTIC LIMIT	- WET - (W)	SEMISOLID; REQUIRES DRYING TO ATTAIN OPTIMUM MOISTURE																																																																	
OM - OPTIMUM MOISTURE	- MOIST - (M)	SOLID; AT OR NEAR OPTIMUM MOISTURE																																																																	
SL - SHRINKAGE LIMIT	- DRY - (D)	REQUIRES ADDITIONAL WATER TO ATTAIN OPTIMUM MOISTURE																																																																	
DRILL UNITS:	ADVANCING TOOLS:	HAMMER TYPE:																																																																	
<input type="checkbox"/> MOBILE B-___	<input type="checkbox"/> CLAY BITS	<input checked="" type="checkbox"/> AUTOMATIC <input type="checkbox"/> MANUAL																																																																	
<input type="checkbox"/> BK-51	<input type="checkbox"/> 6" CONTINUOUS FLIGHT AUGER	CORE SIZE:																																																																	
<input type="checkbox"/> CME-45C	<input type="checkbox"/> 8" HOLLOW AUGERS	<input type="checkbox"/> -B___																																																																	
<input type="checkbox"/> CME-550	<input type="checkbox"/> HARD FACED FINGER BITS	<input type="checkbox"/> -N___																																																																	
<input type="checkbox"/> PORTABLE HOIST	<input type="checkbox"/> TUNG-CARBIDE INSERTS	<input type="checkbox"/> -H___																																																																	
<input checked="" type="checkbox"/> CME-55	<input checked="" type="checkbox"/> CASING <input checked="" type="checkbox"/> W/ ADVANCER	HAND TOOLS:																																																																	
<input type="checkbox"/> _____	<input type="checkbox"/> TRICONE _____ STEEL TEETH	<input type="checkbox"/> POST HOLE DIGGER																																																																	
<input type="checkbox"/> _____	<input type="checkbox"/> TRICONE _____ TUNG-CARB.	<input type="checkbox"/> HAND AUGER																																																																	
<input type="checkbox"/> _____	<input type="checkbox"/> CORE BIT	<input type="checkbox"/> SOUNDING ROD																																																																	
<input checked="" type="checkbox"/> _____	<input checked="" type="checkbox"/> MUD ROTARY	<input type="checkbox"/> VANE SHEAR TEST																																																																	
PLASTICITY										COLOR																																																									
<table border="1" style="width:100%; border-collapse: collapse;"> <thead> <tr> <th>NONPLASTIC</th> <th>PLASTICITY INDEX (PI)</th> <th>DRY STRENGTH</th> </tr> </thead> <tbody> <tr> <td>LOW PLASTICITY</td> <td>0-5</td> <td>VERY LOW</td> </tr> <tr> <td>MED. PLASTICITY</td> <td>6-15</td> <td>SLIGHT</td> </tr> <tr> <td>HIGH PLASTICITY</td> <td>16-25</td> <td>MEDIUM</td> </tr> <tr> <td></td> <td>26 OR MORE</td> <td>HIGH</td> </tr> </tbody> </table>										NONPLASTIC	PLASTICITY INDEX (PI)	DRY STRENGTH	LOW PLASTICITY	0-5	VERY LOW	MED. PLASTICITY	6-15	SLIGHT	HIGH PLASTICITY	16-25	MEDIUM		26 OR MORE	HIGH	DESCRIPTIONS MAY INCLUDE COLOR OR COLOR COMBINATIONS (TAN, RED, YELLOW-BROWN, BLUE-GRAY). MODIFIERS SUCH AS LIGHT, DARK, STREAKED, ETC. ARE USED TO DESCRIBE APPEARANCE.																																										
NONPLASTIC	PLASTICITY INDEX (PI)	DRY STRENGTH																																																																	
LOW PLASTICITY	0-5	VERY LOW																																																																	
MED. PLASTICITY	6-15	SLIGHT																																																																	
HIGH PLASTICITY	16-25	MEDIUM																																																																	
	26 OR MORE	HIGH																																																																	

**NORTH CAROLINA DEPARTMENT OF TRANSPORTATION
DIVISION OF HIGHWAYS
GEOTECHNICAL ENGINEERING UNIT
SOIL AND ROCK LEGEND, TERMS, SYMBOLS, AND ABBREVIATIONS**

ROCK DESCRIPTION		TERMS AND DEFINITIONS	
<p>HARD ROCK IS NON-COASTAL PLAIN MATERIAL THAT IF TESTED, WOULD YIELD SPT REFUSAL. AN INFERRED ROCK LINE INDICATES THE LEVEL AT WHICH NON-COASTAL PLAIN MATERIAL WOULD YIELD SPT REFUSAL. SPT REFUSAL IS PENETRATION BY A SPLIT SPOON SAMPLER EQUAL TO OR LESS THAN 0.1 FOOT PER 60 BLOWS. IN NON-COASTAL PLAIN MATERIAL, THE TRANSITION BETWEEN SOIL AND ROCK IS OFTEN REPRESENTED BY A ZONE OF WEATHERED ROCK. ROCK MATERIALS ARE TYPICALLY DIVIDED AS FOLLOWS:</p>		<p>ALLUVIUM (ALLUV.) - SOILS THAT HAVE BEEN TRANSPORTED BY WATER. AQUIFER - A WATER BEARING FORMATION OR STRATA. ARENACEOUS - APPLIED TO ROCKS THAT HAVE BEEN DERIVED FROM SAND OR THAT CONTAIN SAND. ARGILLACEOUS - APPLIED TO ALL ROCKS OR SUBSTANCES COMPOSED OF CLAY MINERALS, OR HAVING A NOTABLE PROPORTION OF CLAY IN THEIR COMPOSITION, AS SHALE, SLATE, ETC. ARTESIAN - GROUND WATER THAT IS UNDER SUFFICIENT PRESSURE TO RISE ABOVE THE LEVEL AT WHICH IT IS ENCOUNTERED, BUT WHICH DOES NOT NECESSARILY RISE TO OR ABOVE THE GROUND SURFACE. CALCAREOUS (CALC.) - SOILS THAT CONTAIN APPRECIABLE AMOUNTS OF CALCIUM CARBONATE. COLLUVIUM - ROCK FRAGMENTS MIXED WITH SOIL DEPOSITED BY GRAVITY ON SLOPE OR AT BOTTOM OF SLOPE. CORE RECOVERY (REC.) - TOTAL LENGTH OF ALL MATERIAL RECOVERED IN THE CORE BARREL DIVIDED BY TOTAL LENGTH OF CORE RUN AND EXPRESSED AS A PERCENTAGE. DIKE - A TABULAR BODY OF IGNEOUS ROCK THAT CUTS ACROSS THE STRUCTURE OF ADJACENT ROCKS OR CUTS MASSIVE ROCK. DIP - THE ANGLE AT WHICH A STRATUM OR ANY PLANAR FEATURE IS INCLINED FROM THE HORIZONTAL. DIP DIRECTION (DIP AZIMUTH) - THE DIRECTION OR BEARING OF THE HORIZONTAL TRACE OF THE LINE OF DIP, MEASURED CLOCKWISE FROM NORTH. FAULT - A FRACTURE OR FRACTURE ZONE ALONG WHICH THERE HAS BEEN DISPLACEMENT OF THE SIDES RELATIVE TO ONE ANOTHER PARALLEL TO THE FRACTURE. FISSILE - A PROPERTY OF SPLITTING ALONG CLOSELY SPACED PARALLEL PLANES. FLOAT - ROCK FRAGMENTS ON SURFACE NEAR THEIR ORIGINAL POSITION AND DISLOGGED FROM PARENT MATERIAL. FLOOD PLAIN (FP) - LAND BORDERING A STREAM, BUILT OF SEDIMENTS DEPOSITED BY THE STREAM. FORMATION (FM.) - A MAPPABLE GEOLOGIC UNIT THAT CAN BE RECOGNIZED AND TRACED IN THE FIELD. JOINT - FRACTURE IN ROCK ALONG WHICH NO APPRECIABLE MOVEMENT HAS OCCURRED. LEDGE - A SHELF-LIKE RIDGE OR PROJECTION OF ROCK WHOSE THICKNESS IS SMALL COMPARED TO ITS LATERAL EXTENT. LENS - A BODY OF SOIL OR ROCK THAT THINS OUT IN ONE OR MORE DIRECTIONS. MOTTLED (MOT.) - IRREGULARLY MARKED WITH SPOTS OF DIFFERENT COLORS. MOTTLING IN SOILS USUALLY INDICATES POOR AERATION AND LACK OF GOOD DRAINAGE. PERCHED WATER - WATER MAINTAINED ABOVE THE NORMAL GROUND WATER LEVEL BY THE PRESENCE OF AN INTERVENING IMPERVIOUS STRATUM. RESIDUAL (RES.) SOIL - SOIL FORMED IN PLACE BY THE WEATHERING OF ROCK. ROCK QUALITY DESIGNATION (ROD) - A MEASURE OF ROCK QUALITY DESCRIBED BY TOTAL LENGTH OF ROCK SEGMENTS EQUAL TO OR GREATER THAN 4 INCHES DIVIDED BY THE TOTAL LENGTH OF CORE RUN AND EXPRESSED AS A PERCENTAGE. SAPROLITE (SAP.) - RESIDUAL SOIL THAT RETAINS THE RELIC STRUCTURE OR FABRIC OF THE PARENT ROCK. SILL - AN INTRUSIVE BODY OF IGNEOUS ROCK OF APPROXIMATELY UNIFORM THICKNESS AND RELATIVELY THIN COMPARED WITH ITS LATERAL EXTENT, THAT HAS BEEN EMPLACED PARALLEL TO THE BEDDING OR SCHISTOSITY OF THE INTRUDED ROCKS. SLICKENSIDE - POLISHED AND STRIATED SURFACE THAT RESULTS FROM FRICTION ALONG A FAULT OR SLIP PLANE. STANDARD PENETRATION TEST (PENETRATION RESISTANCE) (SPT) - NUMBER OF BLOWS (N OR BPF) OF A 140 LB. HAMMER FALLING 30 INCHES REQUIRED TO PRODUCE A PENETRATION OF 1 FOOT INTO SOIL WITH A 2 INCH OUTSIDE DIAMETER SPLIT SPOON SAMPLER. SPT REFUSAL IS PENETRATION EQUAL TO OR LESS THAN 0.1 FOOT PER 60 BLOWS. STRATA CORE RECOVERY (SREC.) - TOTAL LENGTH OF STRATA MATERIAL RECOVERED DIVIDED BY TOTAL LENGTH OF STRATUM AND EXPRESSED AS A PERCENTAGE. STRATA ROCK QUALITY DESIGNATION (SROD) - A MEASURE OF ROCK QUALITY DESCRIBED BY TOTAL LENGTH OF ROCK SEGMENTS WITHIN A STRATUM EQUAL TO OR GREATER THAN 4 INCHES DIVIDED BY THE TOTAL LENGTH OF STRATA AND EXPRESSED AS A PERCENTAGE. TOPSOIL (TS.) - SURFACE SOILS USUALLY CONTAINING ORGANIC MATTER.</p>	
<p>WEATHERED ROCK (WR)</p> 	<p>NON-COASTAL PLAIN MATERIAL THAT WOULD YIELD SPT N VALUES > 100 BLOWS PER FOOT IF TESTED.</p>		
<p>CRYSTALLINE ROCK (CR)</p> 	<p>FINE TO COARSE GRAIN IGNEOUS AND METAMORPHIC ROCK THAT WOULD YIELD SPT REFUSAL IF TESTED. ROCK TYPE INCLUDES GRANITE, GNEISS, GABBRO, SCHIST, ETC.</p>		
<p>NON-CRYSTALLINE ROCK (NCR)</p> 	<p>FINE TO COARSE GRAIN METAMORPHIC AND NON-COASTAL PLAIN SEDIMENTARY ROCK THAT WOULD YIELD SPT REFUSAL IF TESTED. ROCK TYPE INCLUDES PHYLLITE, SLATE, SANDSTONE, ETC.</p>		
<p>COASTAL PLAIN SEDIMENTARY ROCK (CP)</p> 	<p>COASTAL PLAIN SEDIMENTS CEMENTED INTO ROCK, BUT MAY NOT YIELD SPT REFUSAL. ROCK TYPE INCLUDES LIMESTONE, SANDSTONE, CEMENTED SHELL BEDS, ETC.</p>		
WEATHERING			
<p>FRESH</p>	<p>ROCK FRESH, CRYSTALS BRIGHT, FEW JOINTS MAY SHOW SLIGHT STAINING. ROCK RINGS UNDER HAMMER IF CRYSTALLINE.</p>		
<p>VERY SLIGHT (V SL.)</p>	<p>ROCK GENERALLY FRESH, JOINTS STAINED, SOME JOINTS MAY SHOW THIN CLAY COATINGS IF OPEN, CRYSTALS ON A BROKEN SPECIMEN FACE SHINE BRIGHTLY. ROCK RINGS UNDER HAMMER BLOWS IF OF A CRYSTALLINE NATURE.</p>		
<p>SLIGHT (SL.)</p>	<p>ROCK GENERALLY FRESH, JOINTS STAINED AND DISCOLORATION EXTENDS INTO ROCK UP TO 1 INCH. OPEN JOINTS MAY CONTAIN CLAY. IN GRANITOID ROCKS SOME OCCASIONAL FELDSPAR CRYSTALS ARE DULL AND DISCOLORED. CRYSTALLINE ROCKS RING UNDER HAMMER BLOWS.</p>		
<p>MODERATE (MOD.)</p>	<p>SIGNIFICANT PORTIONS OF ROCK SHOW DISCOLORATION AND WEATHERING EFFECTS. IN GRANITOID ROCKS, MOST FELDSPARS ARE DULL AND DISCOLORED, SOME SHOW CLAY. ROCK HAS DULL SOUND UNDER HAMMER BLOWS AND SHOWS SIGNIFICANT LOSS OF STRENGTH AS COMPARED WITH FRESH ROCK.</p>		
<p>MODERATELY SEVERE (MOD. SEV.)</p>	<p>ALL ROCK EXCEPT QUARTZ DISCOLORED OR STAINED. IN GRANITOID ROCKS, ALL FELDSPARS DULL AND DISCOLORED AND A MAJORITY SHOW KAOLINIZATION. ROCK SHOWS SEVERE LOSS OF STRENGTH AND CAN BE EXCAVATED WITH A GEOLOGIST'S PICK. ROCK GIVES "CLUNK" SOUND WHEN STRUCK. <i>IF TESTED, WOULD YIELD SPT REFUSAL</i></p>		
<p>SEVERE (SEV.)</p>	<p>ALL ROCK EXCEPT QUARTZ DISCOLORED OR STAINED. ROCK FABRIC CLEAR AND EVIDENT BUT REDUCED IN STRENGTH TO STRONG SOIL. IN GRANITOID ROCKS ALL FELDSPARS ARE KAOLINIZED TO SOME EXTENT. SOME FRAGMENTS OF STRONG ROCK USUALLY REMAIN. <i>IF TESTED, YIELDS SPT N VALUES > 100 BPF</i></p>		
<p>VERY SEVERE (V SEV.)</p>	<p>ALL ROCK EXCEPT QUARTZ DISCOLORED OR STAINED. ROCK FABRIC ELEMENTS ARE DISCERNIBLE BUT THE MASS IS EFFECTIVELY REDUCED TO SOIL STATUS, WITH ONLY FRAGMENTS OF STRONG ROCK REMAINING. SAPROLITE IS AN EXAMPLE OF ROCK WEATHERED TO A DEGREE SUCH THAT ONLY MINOR VESTIGES OF THE ORIGINAL ROCK FABRIC REMAIN. <i>IF TESTED, YIELDS SPT N VALUES 100 BPF</i></p>		
<p>COMPLETE</p>	<p>ROCK REDUCED TO SOIL. ROCK FABRIC NOT DISCERNIBLE, OR DISCERNIBLE ONLY IN SMALL AND SCATTERED CONCENTRATIONS. QUARTZ MAY BE PRESENT AS DIKES OR STRINGERS. SAPROLITE IS ALSO AN EXAMPLE.</p>		
ROCK HARDNESS			
<p>VERY HARD</p>	<p>CANNOT BE SCRATCHED BY KNIFE OR SHARP PICK. BREAKING OF HAND SPECIMENS REQUIRES SEVERAL HARD BLOWS OF THE GEOLOGIST'S PICK.</p>		
<p>HARD</p>	<p>CAN BE SCRATCHED BY KNIFE OR PICK ONLY WITH DIFFICULTY. HARD HAMMER BLOWS REQUIRED TO DETACH HAND SPECIMEN.</p>		
<p>MODERATELY HARD</p>	<p>CAN BE SCRATCHED BY KNIFE OR PICK. GOUGES OR GROOVES TO 0.25 INCHES DEEP CAN BE EXCAVATED BY HARD BLOW OF A GEOLOGIST'S PICK. HAND SPECIMENS CAN BE DETACHED BY MODERATE BLOWS.</p>		
<p>MEDIUM HARD</p>	<p>CAN BE GROOVED OR GOUGED 0.05 INCHES DEEP BY FIRM PRESSURE OF KNIFE OR PICK POINT. CAN BE EXCAVATED IN SMALL CHIPS TO PIECES 1 INCH MAXIMUM SIZE BY HARD BLOWS OF THE POINT OF A GEOLOGIST'S PICK.</p>		
<p>SOFT</p>	<p>CAN BE GROVED OR GOUGED READILY BY KNIFE OR PICK. CAN BE EXCAVATED IN FRAGMENTS FROM CHIPS TO SEVERAL INCHES IN SIZE BY MODERATE BLOWS OF A PICK POINT. SMALL, THIN PIECES CAN BE BROKEN BY FINGER PRESSURE.</p>		
<p>VERY SOFT</p>	<p>CAN BE CARVED WITH KNIFE. CAN BE EXCAVATED READILY WITH POINT OF PICK. PIECES 1 INCH OR MORE IN THICKNESS CAN BE BROKEN BY FINGER PRESSURE. CAN BE SCRATCHED READILY BY FINGER NAIL.</p>		
FRACTURE SPACING		BEDDING	
<p>TERM</p>	<p>SPACING</p>	<p>TERM</p>	<p>THICKNESS</p>
<p>VERY WIDE</p>	<p>MORE THAN 10 FEET</p>	<p>VERY THICKLY BEDDED</p>	<p>> 4 FEET</p>
<p>WIDE</p>	<p>3 TO 10 FEET</p>	<p>THICKLY BEDDED</p>	<p>1.5 - 4 FEET</p>
<p>MODERATELY CLOSE</p>	<p>1 TO 3 FEET</p>	<p>THINLY BEDDED</p>	<p>0.16 - 1.5 FEET</p>
<p>CLOSE</p>	<p>0.16 TO 1 FEET</p>	<p>VERY THINLY BEDDED</p>	<p>0.03 - 0.16 FEET</p>
<p>VERY CLOSE</p>	<p>LESS THAN 0.16 FEET</p>	<p>THICKLY LAMINATED</p>	<p>0.008 - 0.03 FEET</p>
		<p>THINLY LAMINATED</p>	<p>< 0.008 FEET</p>
INDURATION			
<p>FOR SEDIMENTARY ROCKS, INDURATION IS THE HARDENING OF THE MATERIAL BY CEMENTING, HEAT, PRESSURE, ETC.</p>			
<p>FRIABLE</p>	<p>RUBBING WITH FINGER FREES NUMEROUS GRAINS; GENTLE BLOW BY HAMMER DISINTEGRATES SAMPLE.</p>		
<p>MODERATELY INDURATED</p>	<p>GRAINS CAN BE SEPARATED FROM SAMPLE WITH STEEL PROBE; BREAKS EASILY WHEN HIT WITH HAMMER.</p>		
<p>INDURATED</p>	<p>GRAINS ARE DIFFICULT TO SEPARATE WITH STEEL PROBE; DIFFICULT TO BREAK WITH HAMMER.</p>		
<p>EXTREMELY INDURATED</p>	<p>SHARP HAMMER BLOWS REQUIRED TO BREAK SAMPLE; SAMPLE BREAKS ACROSS GRAINS.</p>		
<p>BENCH MARK: USGS BM 61MEA 1976</p>		<p>ELEVATION: 11.41 FT.</p>	
<p>NOTES:</p>			
<p>ADDITIONAL ABBREVIATIONS:</p>			
<p>CASREF - CASING REFUSAL</p>			
<p>FIAD - BORING FILLED IN AFTER DRILLING</p>			
<p>CV - CAVED</p>			

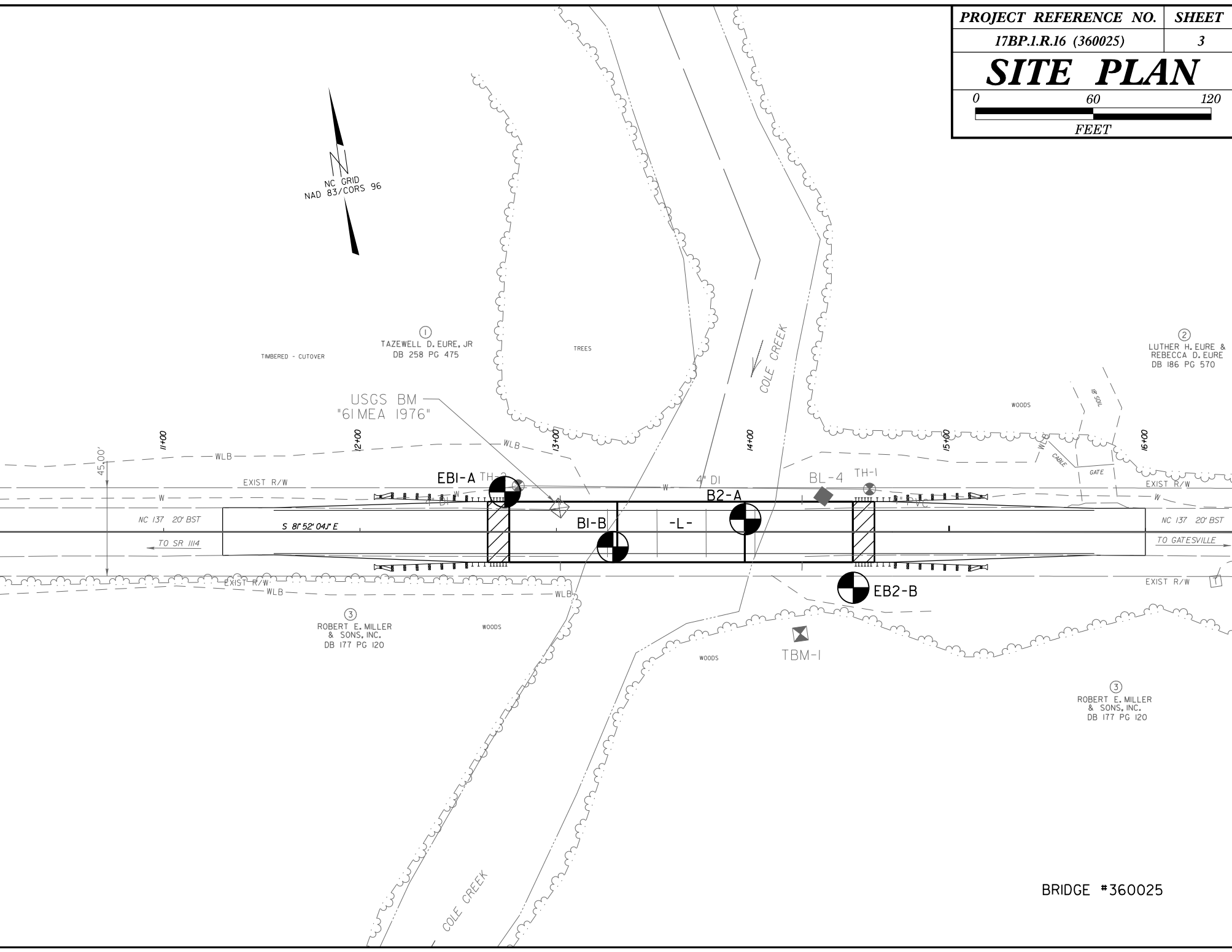

BRIDGE #360025



NCDOT GEOTECHNICAL ENGINEERING UNIT

BORELOG REPORT

WBS 17BP.1.R.16	TIP N/A	COUNTY GATES	GEOLOGIST BACHMAN, M.
SITE DESCRIPTION BRIDGE NO. 360025 ON NC HWY 137			GROUND WTR (ft)
BORING NO. EB1-A	STATION 12+74	OFFSET 20 ft LT	ALIGNMENT -L-
COLLAR ELEV. 9.9 ft	TOTAL DEPTH 90.0 ft	NORTHING 974,942	EASTING 2,651,959
DRILL RIG/HAMMER EFF./DATE CME-55		DRILL METHOD Mud Rotary	HAMMER TYPE Automatic
DRILLER WHICHARD, W	START DATE 04/02/12	COMP. DATE 04/02/12	SURFACE WATER DEPTH N/A

ELEV (ft)	DRIVE ELEV (ft)	DEPTH (ft)	BLOW COUNT			BLOWS PER FOOT					SAMP. NO.	LOG MOI	SOIL AND ROCK DESCRIPTION	DEPTH (ft)			
			0.5ft	0.5ft	0.5ft	0	25	50	75	100					ELEV. (ft)		
10														9.9	GROUND SURFACE	0.0	
	8.9	1.0	4	2	2									6.4	ROADWAY EMBANKMENT DARK GRAY, BROWN, AND ORANGE, LOOSE, SILTY F. SAND (A-2-4)	3.5	
5	6.4	3.5	8	5	3									3.9	ROADWAY EMBANKMENT TAN TO GRAY, LOOSE, CLAYEY F. SAND (A-2-6) W/ WOOD FRAGMENTS		
	3.9	6.0	3	4	2									1.9		8.0	
0	1.4	8.5	1	1	1									-0.1	ALLUVIAL DARK BROWN, SOFT, SILTY CLAY (A-6) W/ TRACE ORGANICS	10.0	
	-3.6	13.5	WOH	4	4												
-5																	
	-8.6	18.5	1	1	4												
-10																	
	-13.6	23.5	3	5	5												
-15																	
	-18.6	28.5	3	5	6												
-20																	
	-23.6	33.5	4	4	7												
-25																	
	-28.6	38.5	3	5	7												
-30																	
	-33.6	43.5	3	5	5												
-35																	
	-38.6	48.5	4	4	6												
-40																	
	-43.6	53.5	3	4	6												
-45																	
	-48.6	58.5	4	4	5												
-50																	
	-53.6	63.5	4	4	6												
-55																	
	-58.6	68.5	4	4	5												
-60																	
	-63.6	73.5	4	4	7												
-65																	
	-68.6	78.5	4	4	6												
-70																	

NCDOT BORE SINGLE GATES_GEO_BRDG0025.GPJ NC_DOT.GDT 7/6/12



NCDOT GEOTECHNICAL ENGINEERING UNIT BORELOG REPORT

WBS 17BP.1.R.16	TIP N/A	COUNTY GATES	GEOLOGIST BACHMAN, M.
SITE DESCRIPTION BRIDGE NO. 360025 ON NC HWY 137			GROUND WTR (ft)
BORING NO. EB1-A	STATION 12+74	OFFSET 20 ft LT	ALIGNMENT -L-
COLLAR ELEV. 9.9 ft	TOTAL DEPTH 90.0 ft	NORTHING 974,942	EASTING 2,651,959
DRILL RIG/HAMMER EFF./DATE CME-55		DRILL METHOD Mud Rotary	HAMMER TYPE Automatic
DRILLER WHICHARD, W	START DATE 04/02/12	COMP. DATE 04/02/12	SURFACE WATER DEPTH N/A

ELEV (ft)	DRIVE ELEV (ft)	DEPTH (ft)	BLOW COUNT			BLOWS PER FOOT					SAMP. NO.	LOG MOI	LOG G	SOIL AND ROCK DESCRIPTION	DEPTH (ft)
			0.5ft	0.5ft	0.5ft	0	25	50	75	100					
-70						Match Line									
-75	-73.6	83.5	4	5	8	•	•	•	•	•		W	/	COASTAL PLAIN BLUE-GRAY, STIFF, SILTY CLAY (A-7) <i>(continued)</i>	
-80	-78.6	88.5	4	5	7	•	•	•	•	•		W	/	Boring Terminated at Elevation -80.1 ft IN CP: SILTY CLAY	90.0

NCDOT BORE SINGLE GATES_GEO_BRDG0025.GPJ NC_DOT.GDT 7/6/12



NCDOT GEOTECHNICAL ENGINEERING UNIT

BORELOG REPORT

WBS 17BP.1.R.16	TIP N/A	COUNTY GATES	GEOLOGIST BACHMAN, M.
SITE DESCRIPTION BRIDGE NO. 360025 ON NC HWY 137			GROUND WTR (ft)
BORING NO. EB2-B	STATION 14+51	OFFSET 28 ft RT	ALIGNMENT -L-
COLLAR ELEV. 7.1 ft	TOTAL DEPTH 90.0 ft	NORTHING 974,868	EASTING 2,652,128
DRILL RIG/HAMMER EFF./DATE CME-55		DRILL METHOD Mud Rotary	HAMMER TYPE Automatic
DRILLER WHICHARD, W.	START DATE 04/03/12	COMP. DATE 04/03/12	SURFACE WATER DEPTH N/A

ELEV (ft)	DRIVE ELEV (ft)	DEPTH (ft)	BLOW COUNT			BLOWS PER FOOT					SAMP. NO.	LOG MOI	SOIL AND ROCK DESCRIPTION	ELEV. (ft)	DEPTH (ft)		
			0.5ft	0.5ft	0.5ft	0	25	50	75	100							
10														7.1	0.0	GROUND SURFACE	
5	6.1	1.0	2	1	1											ROADWAY EMBANKMENT LIGHT BROWN TO BROWN, V. LOOSE TO MED. DENSE, CLAYEY SAND (A-2-6) W/ WOOD FRAGMENTS	
	3.6	3.5	3	21	4												
0	1.1	6.0	1	1	1									0.1	7.0	ALLUVIAL TAN, LOOSE, SLIGHTLY CLAYEY FINE SAND (A-3) AND WOOD FRAGMENTS	
	-1.4	8.5	1	2	8												
-5	-6.4	13.5	5	4	4											ALLUVIAL TAN AND LIGHT GRAY, LOOSE, CLAYEY F. SAND (A-2-6)	
-10	-11.4	18.5	3	1	2												
-15	-16.4	23.5	3	4	7											ALLUVIAL GRAY TO DARK BROWN, V. LOOSE, FINE SAND (A-3) W/ WOOD FRAGMENTS	
-20	-21.4	28.5	4	4	6												
-25	-26.4	33.5	3	4	5												
-30	-31.4	38.5	4	5	5												
-35	-36.4	43.5	3	4	4												
-40	-41.4	48.5	3	4	5												
-45	-46.4	53.5	3	4	4												
-50	-51.4	58.5	3	3	5												
-55	-56.4	63.5	3	3	6												
-60	-61.4	68.5	3	3	6												
-65	-66.4	73.5	3	2	5												
-70																	COASTAL PLAIN BLUE, GRAY, MED. STIFF TO STIFF, SANDY SILTY CLAY (A-7) W/ SHELLS

NCDOT BORE SINGLE GATES_GEO_BRDG0025.GPJ NC_DOT.GDT 7/6/12



NCDOT GEOTECHNICAL ENGINEERING UNIT BORELOG REPORT

WBS 17BP.1.R.16	TIP N/A	COUNTY GATES	GEOLOGIST BACHMAN, M.
SITE DESCRIPTION BRIDGE NO. 360025 ON NC HWY 137			GROUND WTR (ft)
BORING NO. EB2-B	STATION 14+51	OFFSET 28 ft RT	ALIGNMENT -L-
COLLAR ELEV. 7.1 ft	TOTAL DEPTH 90.0 ft	NORTHING 974,868	EASTING 2,652,128
DRILL RIG/HAMMER EFF./DATE CME-55		DRILL METHOD Mud Rotary	HAMMER TYPE Automatic
DRILLER WHICHARD, W.	START DATE 04/03/12	COMP. DATE 04/03/12	SURFACE WATER DEPTH N/A

ELEV (ft)	DRIVE ELEV (ft)	DEPTH (ft)	BLOW COUNT			BLOWS PER FOOT					SAMP. NO.	MOI	LOG	SOIL AND ROCK DESCRIPTION	DEPTH (ft)	
			0.5ft	0.5ft	0.5ft	0	25	50	75	100						
-70						Match Line										
-71.4	-78.5	78.5	3	4	5	•	•••••	•••••	•••••	•••••			W	COASTAL PLAIN BLUE, GRAY, MED. STIFF TO STIFF, SANDY SILTY CLAY (A-7) W/ SHELLS <i>(continued)</i>		
-75						•	•••••	•••••	•••••	•••••			W			
-76.4	-83.5	83.5	3	3	6	•	•••••	•••••	•••••	•••••			W			
-80													W			
-81.4	-88.5	88.5	2	3	5	•	•••••	•••••	•••••	•••••			W			
															-82.9	90.0
Boring Terminated at Elevation -82.9 ft IN CP: SILTY CLAY																

NCDOT BORE SINGLE GATES_GEO_BRDG0025.GPJ NC_DOT.GDT 7/6/12



NCDOT GEOTECHNICAL ENGINEERING UNIT BORELOG REPORT

WBS 17BP.1.R.16		TIP N/A		COUNTY GATES		GEOLOGIST LOFTIN, A.									
SITE DESCRIPTION BRIDGE NO. 360025 ON NC HWY 137							GROUND WTR (ft)								
BORING NO. B1-B		STATION 13+29		OFFSET 8 ft RT		ALIGNMENT -L-									
COLLAR ELEV. 1.0 ft		TOTAL DEPTH 100.8 ft		NORTHING 974,906		EASTING 2,652,009									
DRILL RIG/HAMMER EFF./DATE CME-55				DRILL METHOD Mud Rotary		HAMMER TYPE Automatic									
DRILLER WHICHARD, W		START DATE 04/13/12		COMP. DATE 04/13/12		SURFACE WATER DEPTH 2.8ft									
ELEV (ft)	DRIVE ELEV (ft)	DEPTH (ft)	BLOW COUNT			BLOWS PER FOOT					SAMP. NO.	LOG MOI	SOIL AND ROCK DESCRIPTION	DEPTH (ft)	
			0.5ft	0.5ft	0.5ft	0	25	50	75	100					
5															
0	1.0	0.0	WOH	1	1										
	-0.7	1.8	WOH	1	1										
	-3.2	4.3	WOH	WOH	WOH										
-5	-5.7	6.8	WOH	WOH	1										
	-8.2	9.3													
-10	-13.2	14.3	4	4	4										
	-18.2	19.3	3	4	5										
-15	-23.2	24.3	3	4	6										
	-28.2	29.3	4	4	6										
-20	-33.2	34.3	4	5	7										
	-38.2	39.3	3	5	5										
-25	-43.2	44.3	4	4	5										
	-48.2	49.3	4	3	6										
-30	-53.2	54.3	4	3	6										
	-58.2	59.3	4	4	5										
-35	-63.2	64.3	3	5	5										
	-68.2	69.3	4	4	6										
-40	-73.2	74.3	4	4	6										
-45															
-50															
-55															
-60															
-65															
-70															
-75															

NCDOT BORE SINGLE GATES_GEO_BRDG0025.GPJ NC_DOT.GDT 7/6/12



NCDOT GEOTECHNICAL ENGINEERING UNIT

BORELOG REPORT

WBS 17BP.1.R.16	TIP N/A	COUNTY GATES	GEOLOGIST LOFTIN, A.
SITE DESCRIPTION BRIDGE NO. 360025 ON NC HWY 137			GROUND WTR (ft)
BORING NO. B2-A	STATION 13+96	OFFSET 7 ft LT	ALIGNMENT -L-
COLLAR ELEV. -0.8 ft	TOTAL DEPTH 106.0 ft	NORTHING 974,911	EASTING 2,652,078
DRILL RIG/HAMMER EFF./DATE CME-55		DRILL METHOD Mud Rotary	HAMMER TYPE Automatic
DRILLER WHICHARD, W	START DATE 04/12/12	COMP. DATE 04/12/12	SURFACE WATER DEPTH 3.1ft

ELEV (ft)	DRIVE ELEV (ft)	DEPTH (ft)	BLOW COUNT			BLOWS PER FOOT					SAMP. NO.	LOG MOI	SOIL AND ROCK DESCRIPTION	
			0.5ft	0.5ft	0.5ft	0	25	50	75	100				ELEV. (ft)
0	-0.8	0.0	WOH	WOH	WOH	0								GROUND SURFACE 0.0
-5	-2.8	2.0	WOH	WOH	WOH	0								ALLUVIAL DARK BROWN, V. LOOSE TO LOOSE, CLAYEY F. SAND (A-2-6) W/ LITTLE TO TRACE ORGANICS
-5	-5.3	4.5	WOH	1	3	4								
-10	-7.8	7.0	3	1	1	4								ALLUVIAL DARK BROWN, SOFT, F. SANDY CLAY (A-6)
-10	-10.3	9.5	5	4	5	9								
-15	-15.3	14.5	3	4	5	9								COASTAL PLAIN BLUE-GRAY, STIFF, CLAYEY SILT (A-4) W/ SHELLS AND TRACE ORGANICS
-20	-20.3	19.5	4	5	6	11								
-25	-25.3	24.5	4	5	6	11								
-30	-30.3	29.5	4	6	6	12								
-35	-35.3	34.5	4	4	6	10								
-40	-40.3	39.5	4	5	5	10								
-45	-45.3	44.5	4	4	5	9								
-50	-50.3	49.5	4	4	5	9								
-55	-55.3	54.5	3	4	5	9								
-60	-60.3	59.5	4	4	6	10								
-65	-65.3	64.5	4	5	5	10								
-70	-70.3	69.5	4	5	6	11								
-75	-75.3	74.5	4	4	7	11								
-80														COASTAL PLAIN BLUE-GRAY, STIFF TO SOFT, SILTY AND SANDY CLAY (A-6)

NCDOT BORE SINGLE GATES_GEO_BRDG0025.GPJ NC_DOT.GDT 7/6/12



NCDOT GEOTECHNICAL ENGINEERING UNIT BORELOG REPORT

WBS 17BP.1.R.16			TIP N/A			COUNTY GATES			GEOLOGIST LOFTIN, A.						
SITE DESCRIPTION BRIDGE NO. 360025 ON NC HWY 137									GROUND WTR (ft)						
BORING NO. B2-A			STATION 13+96			OFFSET 7 ft LT			ALIGNMENT -L-						
COLLAR ELEV. -0.8 ft			TOTAL DEPTH 106.0 ft			NORTHING 974,911			EASTING 2,652,078						
DRILL RIG/HAMMER EFF./DATE CME-55						DRILL METHOD Mud Rotary			HAMMER TYPE Automatic						
DRILLER WHICHARD, W			START DATE 04/12/12			COMP. DATE 04/12/12			SURFACE WATER DEPTH 3.1ft						
ELEV (ft)	DRIVE ELEV (ft)	DEPTH (ft)	BLOW COUNT			BLOWS PER FOOT					SAMP. NO.	LOG MOI	L O G	SOIL AND ROCK DESCRIPTION	DEPTH (ft)
			0.5ft	0.5ft	0.5ft	0	25	50	75	100					
-80	-80.3	79.5	4	4	5	Match Line									
-85	-85.3	84.5	3	4	5	9							W	COASTAL PLAIN BLUE-GRAY, STIFF TO SOFT, SILTY AND SANDY CLAY (A-6) <i>(continued)</i>	
-90	-90.3	89.5	3	3	5	8							W		
-95	-95.3	94.5	4	3	5	8							W		
-100	-100.3	99.5	1	3	3	6							W		
-105	-105.3	104.5	3	2	2	4							W		
Boring Terminated at Elevation -106.8 ft IN CP: SILTY AND SANDY CLAY															106.0

NCDOT BORE SINGLE GATES_GEO_BRDG0025.GPJ NC_DOT.GDT 7/6/12